

Approved fasteners
6 - 8 in. O.C. max.

E6100 sealant
1/4 in. (6 mm) min. bead

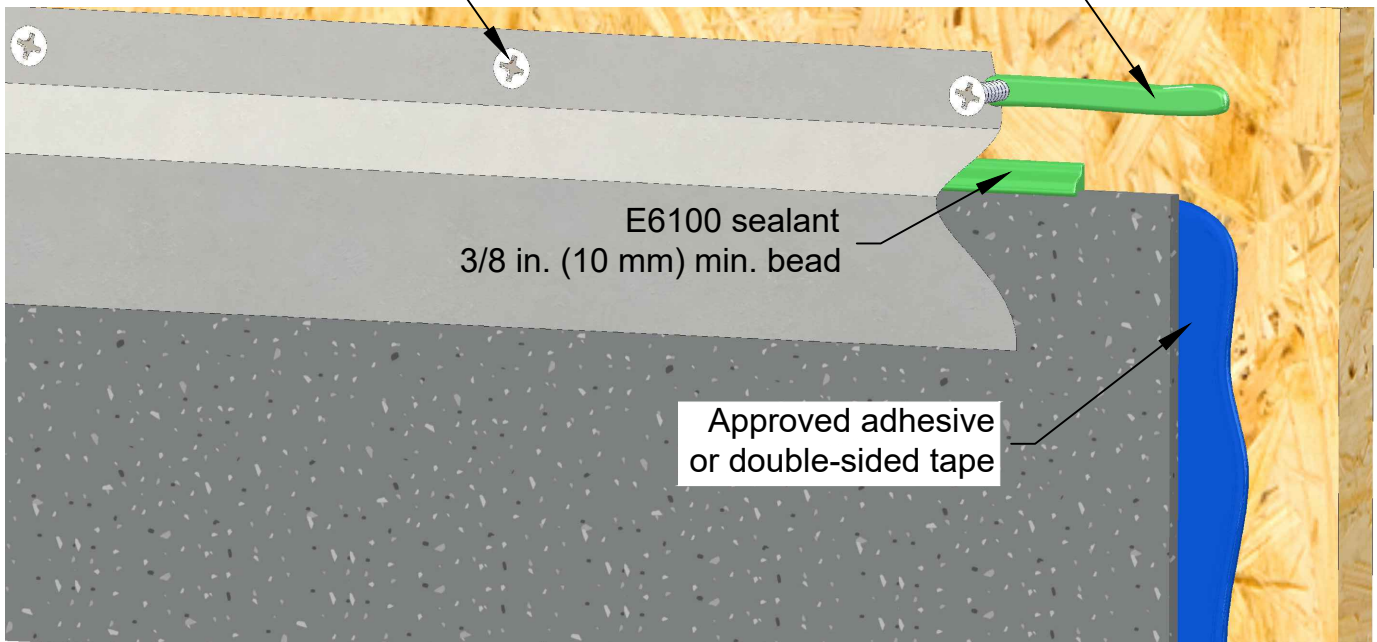

Note: Before fastening corner guard with stainless-steel screws, insert E6100 into the screw holes and attach the corner guard.

REVISED:	N/A	COVE CAP / Z-BAR
PREVIOUS:	04/08/2026	GENERAL DETAIL
SCALE:	NONE	PROTECT-ALL FLOORING